

R48-Mini - 28 and 48VDC Dual Voltage Mount Adapter

The Dual Voltage **R48-Mini** is designed to provide flexible battery power options for high power 48V lighting equipment. The R48-Mini has three mounting options, directly to the light stand (MAF), Quick disconnect to the HC-400 Block (HC), and directly to the back of a Skypanel led light (SKY). The R48-Mini accepts two inputs from any "S" series or "HC" series block batteries in 28vdc mode. In total, the R48-Mini can be equipped with anywhere from 400WHrs to 1600WHrs of battery capacity. The R48-Mini provides one regulated 48V output.

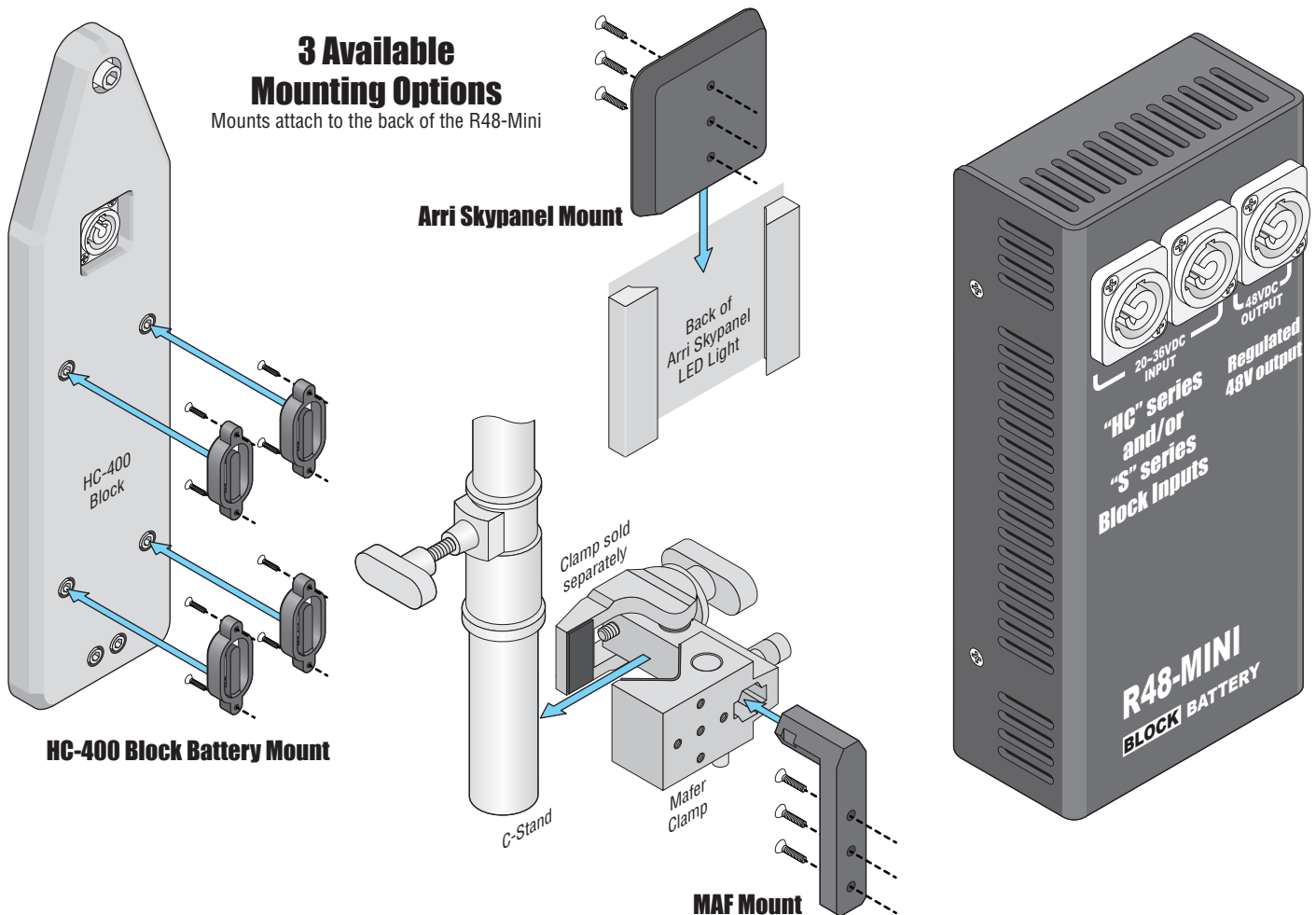

R48-Mini Specifications

R48-Mini Dimensions:

8" (20.3 cm) Height x 3.75" (9.5 cm) Width x 2" (5 cm) Depth

R48-Mini Weight:

2 lbs (.9 Kg)

R48-Mini Output Connectors:

One 48VDC @ 10.4 Amps

R48-Mini Input Connectors:

Two HC400 Blocks 20 ~ 36vdc @ 800WHrs

R48-Mini Features

- The R48-Mini can be conveniently mounted 3 different ways.
- The R48-Mini can power any 48VDC light up to 500 Watts. A great solution for lights and equipment.
- The R48-Mini accepts up to two "S" or "HC" series block batteries. It can be equipped with anywhere from 400WHrs to 1600WHrs of battery capacity.

Estimated run times:

ARRI SkyPanel S60 with (1) HC400 Block = 45 Minutes

ARRI SkyPanel S60 with (2) HC400 Blocks = 1.5 Hours

Fiilex Q1000 with (1) HC400 Block = 1 Hour

Fiilex Q1000 with (2) HC400 Blocks = 2 Hours

For technical support call:

1-888-424-6322